

SOLANO BUSINESS PARK

2300 SOUTH WATNEY WAY | FAIRFIELD



JUST 12 MILES FROM THE HEART OF THE VALLEY,
FAIRFIELD IS THE NEW GATEWAY TO NAPA

±4,800 Square Feet Available



**Newmark
Knight Frank**

GRADEN TRAVIS 925.974.0104 // gtravis@ngkf.com // CA RE License #00871716

TYLER EPTING 925.974.0238 // tepting@ngkf.com // CA RE License #01317533



SOLANO
BUSINESS PARK
2300 SOUTH WATNEY WAY | FAIRFIELD

±4,800
SQUARE FEET
AVAILABLE

**PROJECT
HIGHLIGHTS**

- 4,800 SF available
- One Dock High Door
- One Grade Level Door
- 100 Amps, 120/208v, 3-Phase Electrical Service
- Fully Sprinklered and Insulated
- 19' - 21' Minimum Ceiling Clearance
- Attractive Landscape Amenities
- Ample Parking
- Located in the Prestigious Solano Business Park near HWY 12/I-80 Interchange



GRADEN TRAVIS 925.974.0104 // gtravis@ngkf.com // CA RE License #00871716
TYLER EPTING 925.974.0238 // tepting@ngkf.com // CA RE License #01317533



SOLANO
BUSINESS PARK
 2300 SOUTH WATNEY WAY | FAIRFIELD

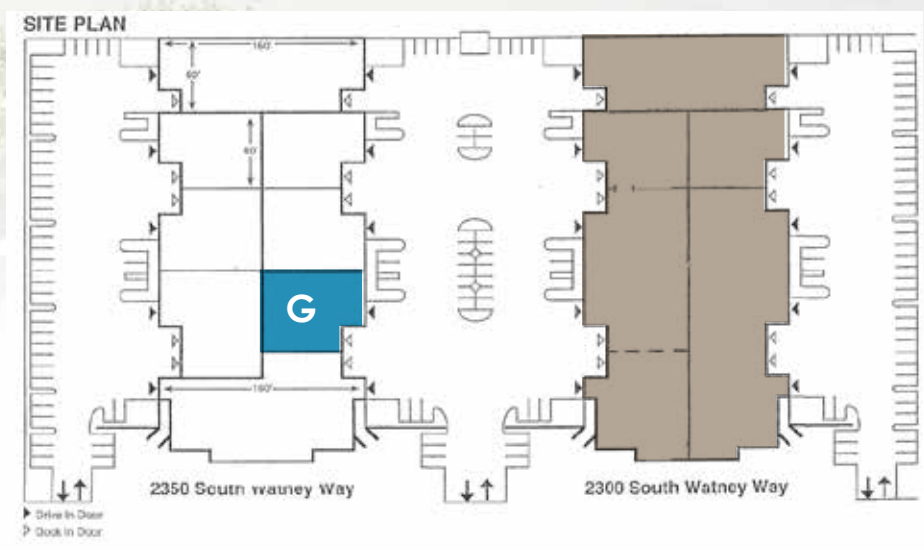

SUITE I - G
TOTAL SQUARE FEET ±4,800 SF

SUITE G - ±4,800 SQUARE FEET

- ±350 SF of office including a reception area and a private office
- Dock and Grade level loading
- Sprinklered throughout

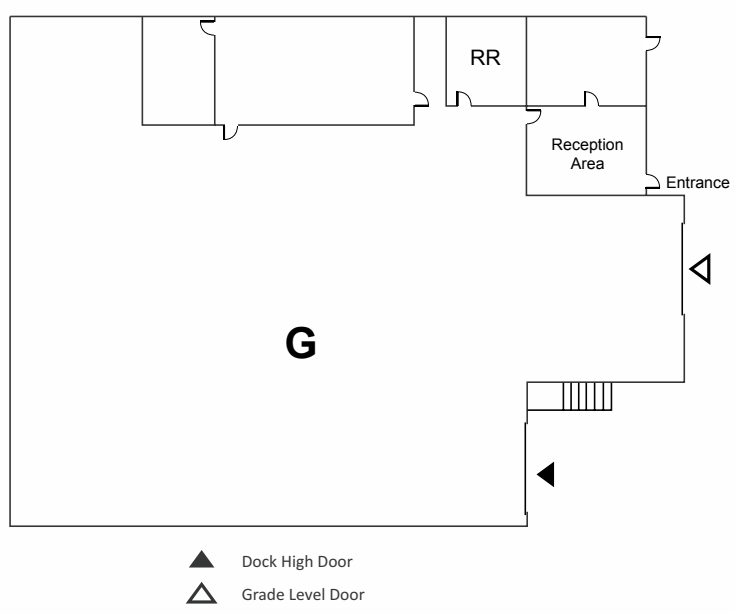

GRADEN TRAVIS 925.974.0104 // gtravis@ngkf.com // CA RE License #00871716
TYLER EPTING 925.974.0238 // tepting@ngkf.com // CA RE License #01317533



GRADEN TRAVIS 925.974.0104 // gtravis@ngkf.com // CA RE License #00871716
TYLER EPTING 925.974.0238 // tepting@ngkf.com // CA RE License #01317533

